

TEL: 805.983.8008
3451 LUNAR COURT
OXNARD, CA 93030
WWW.SOUNDSTORMLAB.COM

SOUND STORM[®]
LABORATORIES



SOUND STORM[®]
LABORATORIES

User's Manual

SCD-750R

CONTENTS

Installation	2
DIN Front-Mount (Method A)	2
Installing the unit	2
Removing the unit	3
DIN Rear-Mount (Method B)	3
Using the Detachable Front Panel	4
Wiring Connection	5
Operation	6
TroubleShooting	11
Specifications	12

INSTALLATION

Notes:

- Choose a mounting location where the unit will not interfere with the driver's ability to control the vehicle.
- Before final installation, temporarily connect the wiring. Make sure all connections are done correctly, and that the system operates properly.
- Use only the parts included with the unit to ensure proper installation. The use of unauthorized parts can cause malfunctions.
- Consult with your nearest dealer if installation requires the drilling of holes or other modifications to the vehicle.
- If installation angle exceeds 30° from horizontal, the unit might not give its optimum performance.



- Install the unit only where it is not subject to excessive temperature from heated air or direct sunlight, or where it is protected from dust, dirt and excessive vibration.

DIN FRONT/REAR-MOUNT

This unit can be properly installed either from "Front" (conventional DIN Front-mount) or "Rear" (DIN Rear-mount installation, utilizing threaded screw holes at the sides of the unit chassis). For details, refer to the following illustrated installation methods.

DIN FRONT-MOUNT (Method A)

Installing the unit

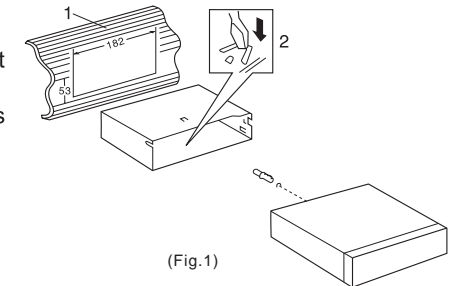

1. Dashboard
2. Mounting Bracket
After inserting the holder into the dashboard, select the appropriate tabs according to the thickness of the dashboard material and bend them outward to secure the bracket in place.
3. Screw

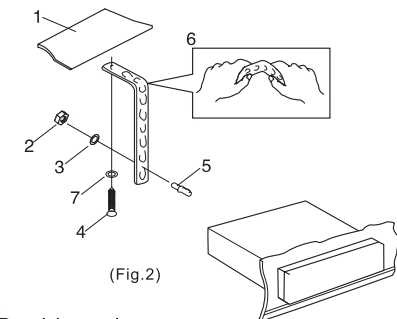

1. Dashboard
2. Nut (5mm)
3. Spring washer
4. Screw (5 x 25mm)
5. Screw
6. Backstrap
Be sure to use the back-strap to secure the back of the unit in place. The back-strap can be bent by hand to the desired angle.
Note: The trim piece, backstrap, and mounting bracket are not used for REAR-MOUNT.
7. Plain washer

INSTALLATION

Removing the unit

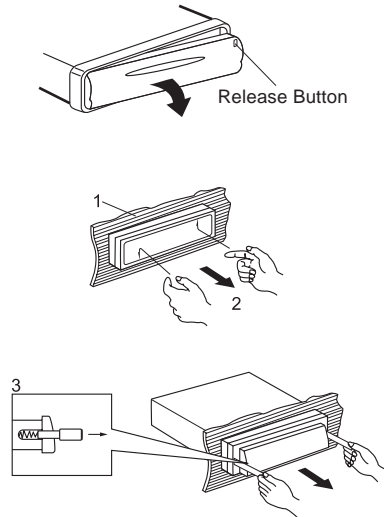

1. Before removing the bezel, press the **RELEASE** button to remove the front panel.
2. Insert fingers into the groove in the right side of the frame and pull out to remove the frame. (You can also remove the frame from the left side.)
3. Then insert the levers supplied with the unit into the grooves at both sides of the unit as shown in figure until they click. Pulling the levers makes it possible to remove the unit from the dashboard.

DIN REAR-MOUNT (Method B)

Installation using the screw holes on the sides of the unit.

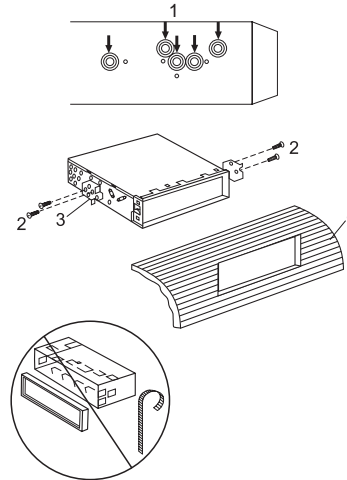

Fastening the unit to the factory radio mounting bracket.

1. Select a position where the screw holes of the bracket and the screw holes of the main unit become aligned (are fitted), and tighten the screws at 2 places on each side. Use either truss screw (5 x 5mm) or flush surface screw (4 x 5mm), depending on the shape of the screw holes in the bracket.
2. Screw
3. Factory radio mounting bracket
4. Dashboard or Console

Note: The trim piece, backstrap, and mounting bracket are not used for REAR-MOUNT.

USING THE DETACHABLE FRONT PANEL

DETACHING THE FRONT PANEL

To slide down the front panel, press the **OPEN/EJECT** button.

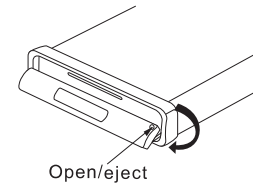

When the front panel is in the **DOWN** position, press the release button on the rear of the front panel toward the front of the unit, and pull the panel out of the panel bracket.

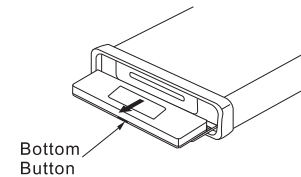

Pressing the **OPEN/EJECT** button again will cause the front panel to slide up.

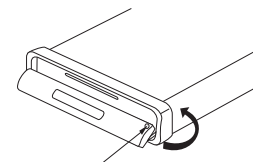

For safekeeping, store the front panel in the supplied protective case immediately after being removed.

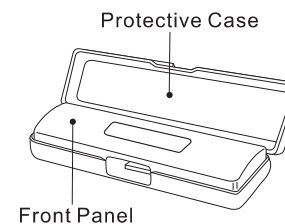

Front Panel

To Reinstall the Front Panel

1. When the panel bracket is in the **DOWN** position, insert the front panel into the bracket. Press **OPEN** to slide up.

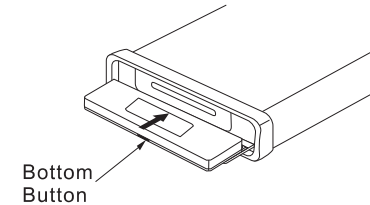

2. When the panel is in the **UP** position, insert one side of the panel in its proper position, and push the other side into the bracket, until you hear a "click".

Front Panel

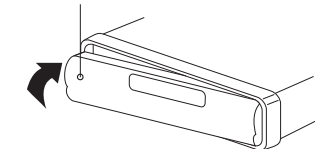

3. Note that if the front panel fails to lock in position properly, some controls and functions may not work and some segments of LCD display may be missing. Press the **OPEN** button and then reinstall the front panel again.

WIRING CONNECTION

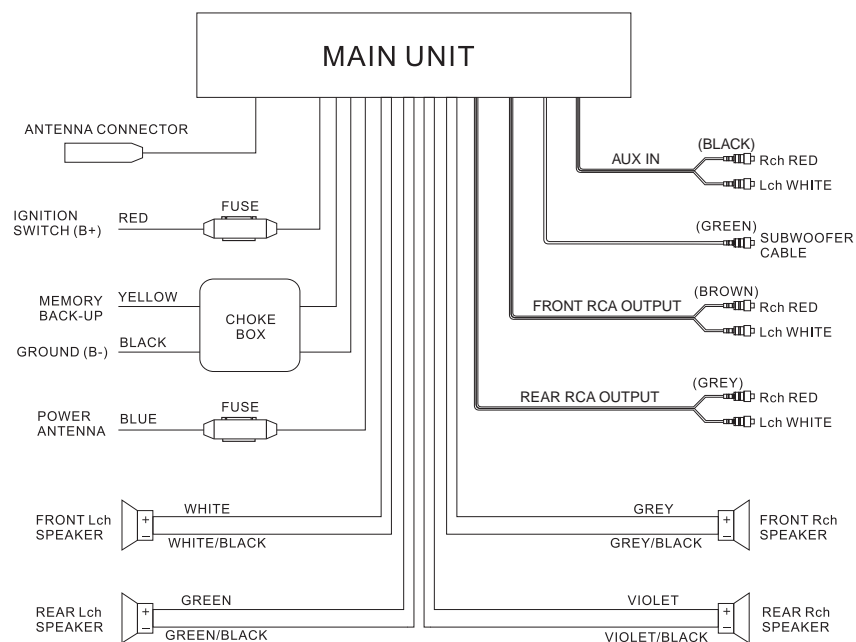

AUXILIARY INPUT FEATURE

This CD Receiver features an Auxiliary Input jack on the back side of the unit. An external audio source such as a portable audio player or a DVD player may be connected via this input jack.

OPERATION

GENERAL CONTROLS

POWER Press any button to turn unit ON. To turn head unit off, press and hold POWER.

EJECT Press to eject CD.

DISPLAY To set clock, press and hold, then press the TUNE/TRACK $\blacktriangleright\blacktriangleleft$ to change hours, $\blacktriangleleft\blacktriangleleft$ for minutes.

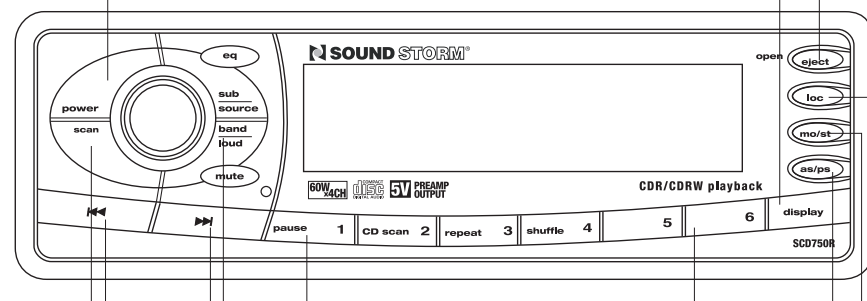

RADIO CONTROLS

STATION PRESETS Press any preset to select a station. To store a station in memory, tune to it, and press and hold your choice of preset button for several seconds.

BAND Press repeatedly to change between three FM bands/one AM band

TUNE/TRACK BUTTONS When pressed short, these keys are operated as MANUAL tuning mode. When pressed longer than 1 sec., they are operated as SEEK tuning mode.

SCAN Press and Hold this button to engage function which will search for stations, playing each for five seconds before moving to next station.

AS/PS When pressed and hold for several seconds, the tuner will search and store the first six strong stations as presets.

MO/ST Press if reception becomes noisy. Press again for normal stereo reception.

LOC Press to select between strong (LOC) and weak (DIST) stations.

OPERATION

AUDIO CONTROLS

EQ Press repeatedly to cycle through five modes: FLAT, CLASSICAL, POP M, JAZZ M or DSP OFF.

LOUDNESS Press and hold to increase the level of bass output.

SUB Press and hold to engage output ("SUBWOOFER" will appear in display).
SOURCE Press repeatedly to choose desired audio source (Radio, CD or AUX in).

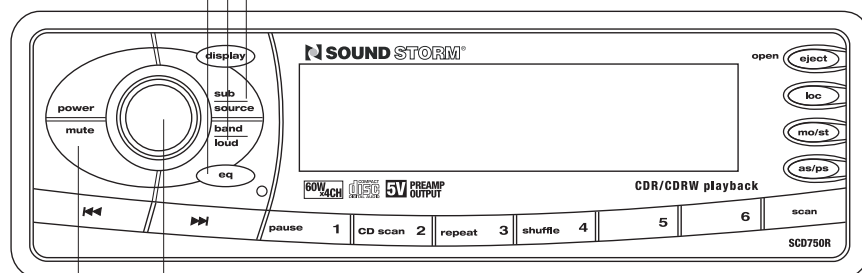

AUDIO BUTTON and ROTARY CONTROL Press the button repeatedly to access Volume, Bass, Treble, Balance and Fader functions. Then use the knob control to adjust the select function.

MUTE Press to silence the receiver. Press again to return to normal operation

OPERATION

CD PLAYBACK CONTROLS

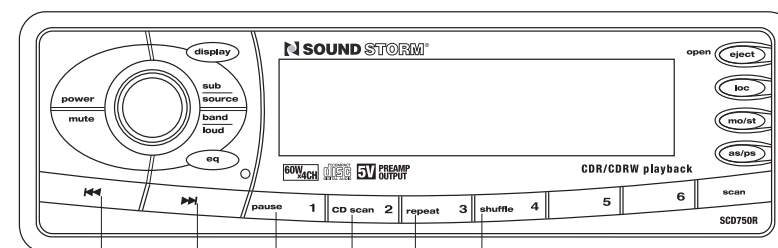

SHUFFLE Press to play ALL tracks on the CD in random order.

REPEAT Press and release to continuously repeat same track. Press again to stop repeat cycle.

CD SCAN Press to hear first several seconds of each track on current disc. Press again to stop intro and listen to intro last previewed.

PAUSE Press to pause CD playback. Press again to resume playback.

TUNE/TRACK BUTTONS Press and release to advance to next track or to return to the beginning of the current track (track number will be displayed). Press and hold to fast forward or reverse. Play will begin at the point when you release the button.

CD OPERATION

To PLAY a CD gently insert a CD with the label side up into the disc slot. It will automatically load and begin playing the first track.

To EJECT a CD press EJECT to stop the CD playback and eject the CD from the slot. The receiver will automatically switch to radio mode.

To PAUSE a CD press PAUSE to stop playback temporarily. Press again to resume playback.

To SKIP TRACKS press the **◀◀** or **▶▶** key to choose the next or preceding track.

To FAST FORWARD or REVERSE press and hold the **◀◀** or **▶▶** key to the desired location on the disc. Releasing the button starts playback at the location.

To REPEAT a track press REPEAT to continuously repeat the current track. Press again to return to normal playback mode.

To PREVIEW ALL TRACKS press CD SCAN to play the first several seconds of each track. Press it again to stop and play the current track being previewed.

To PLAY TRACKS IN RANDOM ORDER press SHUF to play ALL tracks on the CD in random order. Press again to cancel this function.

OPERATION

CONTROLS BEHIND FACEPLATE

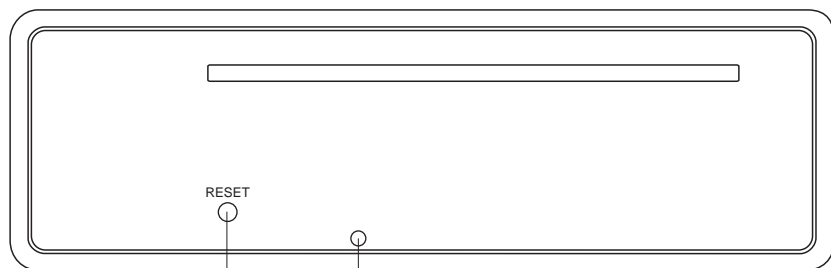

LED This LED flashes when the faceplate is removed.

RESET BUTTON Press this button with a ballpoint pen or other thin object. Use it:
 . after initial installation of the unit, when all wiring is complete
 . when the function buttons do not operate
 . when the display is showing "ERROR"

NOTE: If the unit does not function properly after you have pressed the RESET button, clean the socket and the connector on the rear of the front panel with a cotton swab soaked in isopropyl alcohol and try again.

OPERATION

REMOTE CONTROL FUNCTIONS

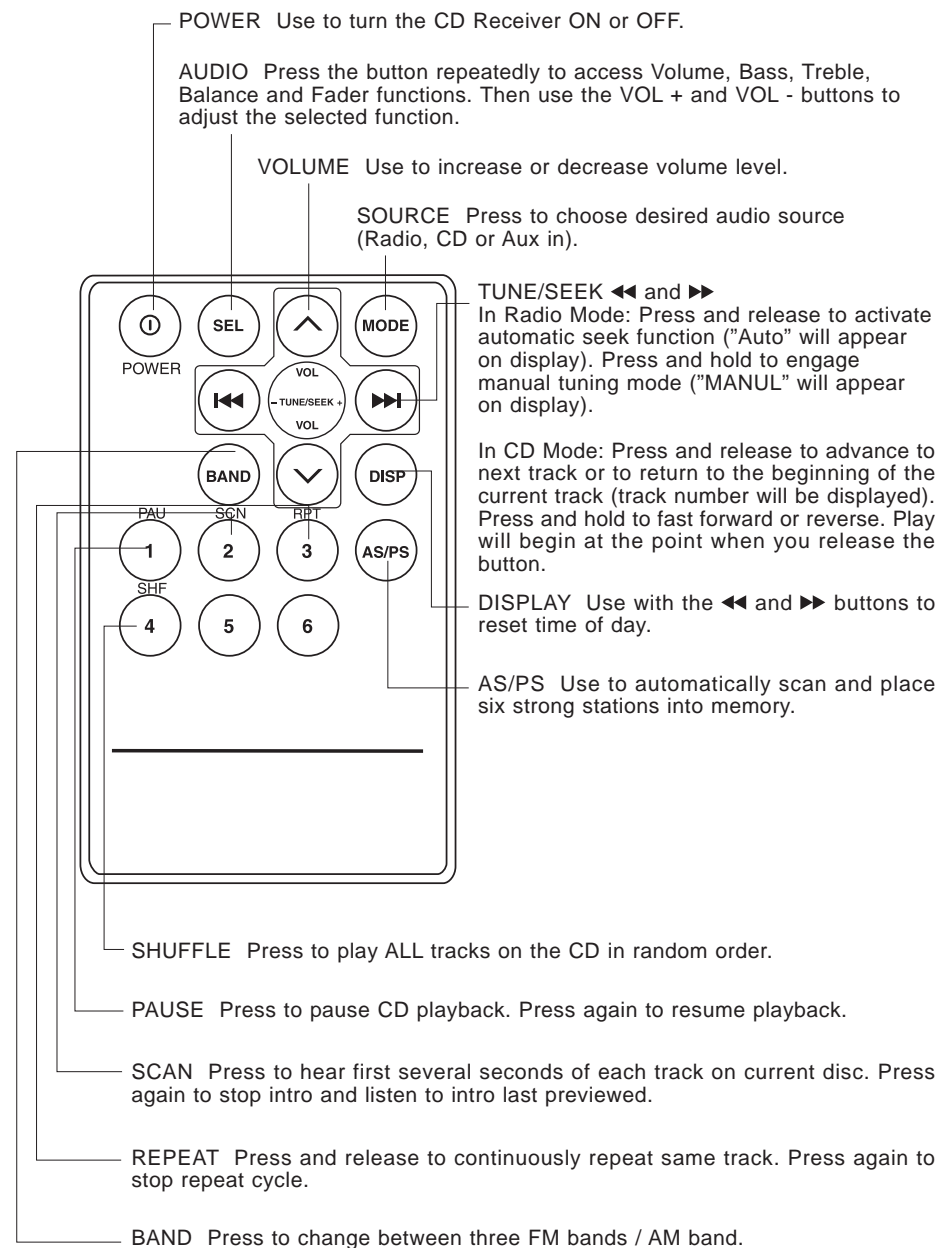

TROUBLESHOOTING

Before going through the check list, check wiring connection. If any of the problems persist after check list has been made, consult your nearest service dealer.

Symptom	Cause	Solution
No power.	The car ignition switch is not on.	If the power supply is properly connected to the car accessory circuits, but the engine is not moving, switch the ignition key to "ACC".
	The fuse is blown.	Replace with a new fuse of equal rating
Disc cannot be loaded or ejected.	A CD is in the player.	Remove the disc in the player, then put a new one.
	Disc is inserted upside down	Insert the CD with the label facing up.
	CD is very dirty or defective.	Clean the disc or try to play a new one.
	Temperature inside the car is too high.	Allow the ambient temperature to cool down to a normal level.
	Condensation is present in the CD player.	Leave the player off for an hour or so, then try again.
No sound.	Volume control is set to the minimum level.	Adjust volume to a desired level.
	Wiring is not properly connected.	Check wiring connection.
Sound skips.	The installation angle is more than 30 degrees.	Make sure the head unit is installed at an angle of less than 30 degrees from horizontal.
	The disc is extremely dirty or defective disc.	Clean the compact disc, then try to play a new one.
The operation keys do not work.	The built-in microcomputer is not operating properly due to noise.	Press the RESET button and try again.
	Front panel is not attached or seated properly.	Remove and reinsert the front panel according to the instructions in this manual and try again.
The radio does not work. The radio station automatic selection does not work.	The antenna cable is not connected.	Insert the antenna cable firmly.
	The signals are too weak.	Select a station manually.

SPECIFICATIONS

CD PLAYER

Signal to Noise Ratio	: More than 60 dB
Channel Separation	: More than 60 dB
Frequency Response	: 20 Hz- 20KHz

RADIO

Frequency Coverage	FM : 87.5 to 107.9 MHz
IF	: 10.7 MHz
Sensitivity (S/N = 30dB)	: 3 µV
Stereo Separation	: >30 dB

Frequency Coverage	AM : 530 to 1710KHz
IF	: 450KHz
Sensitivity (S/N=20dB)	: 32dBu

GENERAL

Tone Controls	
- Bass (at 100 Hz)	: ± 10 dB
- Treble (at 10 KHz)	: ± 10 dB
Maximum Output Power	: 60 Watts x 4
Power Supply Requirements	: DC 12 Volts, Negative Ground
Current Consumption	: 7 Amperes (max.)
Dimensions	: 178 (W) x 180 (D) x 50 (H) mm 7"x 6.1"x 1.9"
Weight	: 2 kg 4.4 lb