

M312USA

MP3-COMPATIBLE AM/FM CD RECEIVER

WITH USB AND SD MEMORY CARD PORTS AND FRONT PANEL AUX INPUT

12.2009

User's Manual



SOUNDSTORM[®]
L A B O R A T O R I E S

3451 LUNAR COURT, OXNARD CA 93030

PHONE: 888.38.STORM

805.983.8008

FAX: 805.983.7068

TECHNICAL SUPPORT:

www.soundstormlab.com



iPod is a trademark of Apple, Inc.,
registered in the U.S. and other countries.

M312USA

MP3-COMPATIBLE AM/FM CD RECEIVER

**WITH USB AND SD MEMORY CARD PORTS
AND FRONT PANEL AUX INPUT**

Preface

Thank you for purchasing this car audio product.

Please read this manual carefully before operating this car audio product.

Please keep this manual for future use. It will be helpful to you if you are encounter any operational problem.

Selecting fine audio equipment is only the start of your musical enjoyment.

Now it is time to consider how to maximize the enjoyment you will get from knowing how to work your new car stereo receiver.

We hope you enjoy using this product and encourage you to always listen at a moderate, safe sound level to avoid any possible hearing damage or loss.

If you listen to excessively loud sound over time, your hearing can adapt to higher volumes and what sounds "normal" to you may be quite harmful and can cause you to have permanent hearing loss. So please practice "safe sound" and always listen at moderate sound levels only.

Start with your volume control at the lowest setting, and slowly increase the level until you can hear it comfortably and clearly, free from distortion.

Once you have established this comfortable sound level, leave it there.

WARNING!

To prevent direct exposure to laser beam, do not try to open the enclosure.

Visible and invisible laser radiation will damage your eyes.

To protect our environment, do not dispose of electrical equipment in the domestic waste.

Please return any electrical equipment that you will no longer use to the collection points provided for their disposal.

This helps avoid the potential effects of incorrect disposal on the environment and human health. This will contribute to the recycling and other forms of reutilization of electrical and electronic equipment. Information concerning where the equipment can be disposed of can be obtained from your local authority.

WIRES CONNECTION

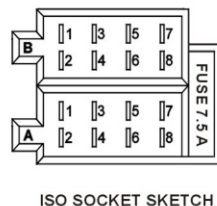
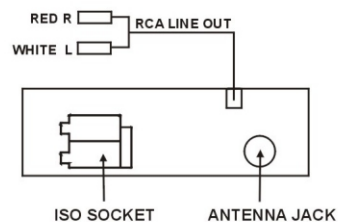

CONNECTOR A

- 1.
- 2.
- 3.
4. Memory +12V(yellow)
5. Auto Antenna (blue)
- 6.
7. ACC Ignition (red)
8. GROUND(black)

CONNECTOR B

1. Rear Right Speaker (+)
2. Rear Right Speaker (-)
3. Front Right Speaker (+)
4. Front Right Speaker (-)
5. Front Left Speaker (+)
6. Front Left Speaker (-)
7. Rear Left Speaker (+)
8. Rear Left Speaker (-)

SPECIFICATION

GENERAL

Supply Voltage	DC 12 V. Negative Ground
Current Consumption	Max.7A
Power Output	60Watts X 4ch
Number of channels	4 STEREO channels.
Unit Dimensions	178[W] X 165[D] X 50[H] mm. 7[W] X 6.5[D] X 2[H] inch.

FM SECTION

Frequency range	87.5MHz -107.9MHz
Effective sensitivity	3uV.
I.F Frequency	10.7MHz.

AM SECTION

Frequency range	530KHz - 1710KHz
Effective sensitivity	40dB.
I.F Frequency	450KHz

RCA LINE OUT

Output	1000mV @ CD MAX.
--------	------------------

CD PLAYER

System	MP3 Audio System.
Suitable CDs	MP3, WMA, CD,CD-R,CD-RW Disc
Frequency characteristics	20Hz-100Hz ≤ 5dB 10KHz-20KHz ≤ 5dB.
S/N Ratio to CD	50dB [1KHz]

LOCATION AND FUNCTION OF CONTROLS

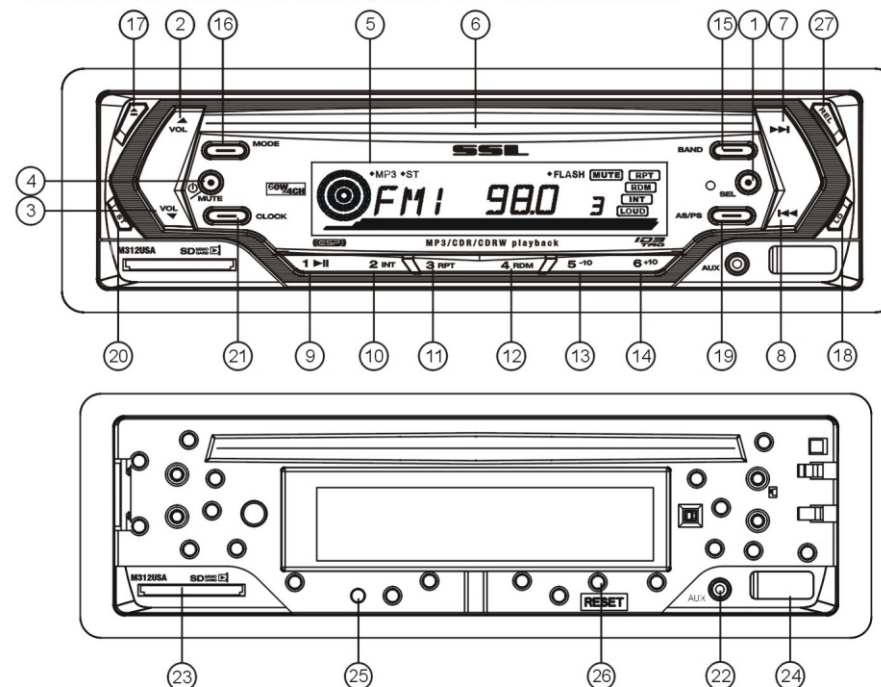

1,2 & 3.SEL(MENU) BUTTON AND VOLUME UP (+) / DN (-) BUTTONS

a) Press the SEL button briefly, repeatedly, to select desired mode.

-> VOLUME ->BASS ->TREBLE -> BALANCE -> FADER ->

When selecting a desired audio mode, press the VOL+ or VOL- button to adjust the audio effect.

In each mode, the waiting time is about 5 seconds, and when the waiting time is over, it returns to the last display mode of tuner or CDP mode.

The control mode of E.VOL is operated with following numeric display.

- VOL: (MIN)00, 01,.....46, 47(MAX).
- BASS/TRE: -07, -06,....,00,...+06,+07
- BAL: 0LR9, 1LR9, ..., 9LR9,...., 9LR1, 9LR0
- FAD: 0FR9,1FR9, ..., 9FR9,...., 9FR1, 9FR0

b) Pressing and holding the SEL button for longer than two seconds activates the cyclical mode of functions:

->BEEP (ON/OFF) -> USER SET(FLAT/CLASSIC/ROCK/POP)
->VOL(LAST/DEFA) ->CLK(ON/OFF)->CLK(12/24)mode.

When selecting a desired audio mode, press the VOL+ or VOL- button to adjust the audio effect.

BEEP ON/BEEP OFF

BEEP ON mode: The beep is generated when any key is pressed.

BEEP OFF mode: The beep sound is disabled.

VOL LAST/VOL DEFA

VOL LAST: The radio switches on at the actual volume it was set before it was last switched off.

VOL DEFA: After pressing SEL button, VOL will be displayed. Then you can pre-select a constant switch-on volume by using the VOL knob.

CLK ON/OFF

CLK ON: Clock will always show on the display when power is off.

CLK OFF: Clock will not show on the display when power is off.

4. POWER ON/OFF & MUTE

When the unit is power off, the unit will turn on by pressing any button except the EJECT and the RELEASE button.

When the unit is power on, press and hold the power button for more than 0.5 seconds, turns the unit off.

When the unit is power on, pressing the power briefly will turn the MUTE on/off.

5. LCD Display

6. CD SLOT

7&8. TUNE, SEEK, TRACK, SKIP UP / DOWN BUTTONS

a) During RADIO mode:

Press the >>| or |<< button briefly to manually tune up/down to the desired radio station frequency step by step.

Press and hold the >>| or |<< button for longer than 0.5 seconds, to automatically tune up/down to the radio station frequency of strong signal.

b) During disc, MMC/SD, USB playback mode:

Press the >>| button briefly to play next track.

Press the |<< button briefly to play the current track from the beginning of it if the playing time is more than 2 seconds.

Press the |<< button briefly to play the previous track if the playing time is less than 2 seconds.

Press the >>| or |<< button and hold to skip forwards or backwards, release to resume normal playback.

9-14. PRESET STATION MEMORIES 1-6(||, INT, RPT, RDM) BUTTONS

a) During radio mode:

When pressed briefly, these buttons select a preset pre-programmed stations. If any of the six buttons are pressed for more than 2 seconds, the station currently being listened to is memorized into the selected preset button.

b) During disc, MMC/SD or USB mode:

- 1) Press the TOP/ >|| button briefly to pause the playback of the disc, MMC/SD or USB. Press again to resume normal playback of the disc, MMC/SD or USB. Press the TOP/ >|| button and hold for approximately 0.5 seconds to play the first track of the disc, MMC/SD or USB.
- 2) Press the INT button to sample the first 10 seconds part of each track, and the INT ON will be visible on the LCD display. In the process of INT, press INT button again to stop sampling and to continue playing the current track, and the LCD will display INT OFF.
- 3) Press the RPT button once to play the current track repeatedly, and the RPT ONE will be visible on the LCD display. During MP3/WMA disc, MMC/SD or USB mode, press the RPT button twice continuously to play the current folder repeatedly, and the RPT ABM will be visible on the LCD display. In the process of RPT, press RPT button again to stop playing repeatedly mode and the LCD will display RPT OFF.

TROUBLE SHOOTING

Before using the check list please make all the connections first.

If you still have questions after going through the checklist, please consult your local customer service representative.

Common Symptoms	Cause	Solution
There is no power.	The car ignition is switched off.	If the power supply is properly connected to the car accessory, switch the ignition key to " ON " or " ACC " .
	The fuse has blown.	Replace another fuse with the same amperage rating.
The CDs cannot be loaded.	Presence of CD disc inside the player	Remove the disc from the player
The CDs are loading only halfway into the CD tray.	The transport screws have not been removed.	Remove the transport screws before using.
The device does not work correctly (EJECT, LOAD, PLAY)	Inserted disc is upside down	Insert the compact disc with the label facing upward
	The surface of CD is extremely dirty or it is damaged.	Clean the CD or try another CD, if this works correctly, the first CD is properly damaged.
	Temperature inside the car is too high.	Cool off until the ambient temperature returns to normal
There is no sound.	The volume control is set too low.	Turn up the volume properly.
	The device has not been wired correctly.	Check the connections according to the wiring diagram.
The operation keys do not work	1.The built-in microcomputer is not operating properly 2.Front panel is not properly fix into its place	1. Switch the device off and on again. Or press the RESET button. 2. Reinstall the front panel
The sound of the CD player skips	The installation angle is more than 30 degrees	Adjust the installation angle to less than 30 degrees
	The surface of the road is uneven.	Wait until the road becomes smoother before playing the CD.
	The surface of CD is extremely dirty or it is damaged.	Clean the CD or try another CD, if this works correctly, the first CD is properly damaged.
No radio reception.	The antenna cable is not connected.	Insert the antenna cable firmly into the antenna socket of the device.
In automatic search mode the radio does not stop at a transmitting station.	The transmission signals are too weak.	Tune in to a radio station manually.

CARE FOR USING CD'S:

About MP3/CD-R/CD-R/W discs:

In addition to commercially-recorded audio CD's, this unit can play MP3, CD-R and CD-R/W discs. In some cases, particularly when recorded on older CD burners, some MP3, CD-R and CD-R/W discs may not play. Also, whenever you are recording a CD for playback in this receiver, it is recommended that you record at 24x or slower speed for CD-R and 4x or slower for CD-R/W to achieve higher signal quality and better playback performance.

1. To keep the disc clean:
Do not attach any sticker or adhesive tape on the disc.
Handle the disc by its edge to keep the disc clean and do not touch the surface.
Before playing a disc, wipe it off with a clean, dust-free cleaning cloth.
Wipe the disc outwards from the disc center.
2. When one disc has already been inserted. Inserting another disc will damage the unit. Insert a disc with labeled surface up, or it will damage the unit.
3. Do not expose the disc to direct sunlight or nearby heat sources such as heating vents, which can cause the disc to warp.
Do not leave disc in a car if it is parked in direct sunlight as that will lead to a considerable rise in the temperature inside the car.
4. Always store the disc in its case for protection. Scratched up discs will produce poor sound performance and cause CD player to skip.
5. In raining day or wet area, the moisture may form on the disc or the optical parts, the playback may not be possible. If moisture forms on the disc, wipe it off with a soft cloth.
6. Do not use solvents such as benzine or thinners. Commercially available cleaners or anti-static spray will damage the unit.



- 4) Press the RDM button to play all tracks on disc in random order, and the RDM ON will be visible on the LCD display.
In the process of RDM, press RDM button again to stop playing in random order and the LCD will display RDM OFF.
- 5) Press the -10 and +10 button to move up and down 10 tracks at a time.

15. BAND BUTTON

During radio mode:

Press the BND button briefly to select the radio broadcasting band you would like to hear. The AM/FM band is toggled cyclically through the tuning bands: -> FM 1 -> FM 2 -> FM 3 -> AM 1 -> AM 2 ->.

Press and hold the BND button to select LOCAL/DX mode.

Note: This button is only active for FM reception.

In MMC/SD, USB mode, the file name, folder name, song's title, artist and album information will be scrolling on the LCD display.

As long as the current playing MP3/WMA music contains relevant ID3 tag information in version 1.0/2.0 format, the 3 items underlined above will be scrolling on the LCD display; otherwise, they will not.

16. MODE BUTTON

Press the MODE button to change among tuner (radio), disc (when a disc is loaded), MMC/SD card (when an MMC/SD card is inserted), USB (when a USB stick is inserted) and AUX mode.

17. EJECT BUTTON

When the power is on, the loaded disc can be ejected by pressing the EJ button.

18. LOUDNESS BUTTON

When pressed briefly, the LOUD mode is turned on, its to enhance the bass sound effect when the volume level is low. Press again to cancel the loudness effect.

19. AS/PS BUTTON (Auto-storage/Preset scan)

During radio mode:

1) When pressed and held for more than 1 second, the radio searches from the current frequency and checks the signal strength level until 6 stations are found. And then the 6 stations frequency are preset to the corresponding preset memory numbered bank.

2) When pressed briefly, the radio searches for each preset station in the current band and plays that preset station for 5 seconds, and then searches again.

During MP3/WMA file in disc, MMC/SD or USB mode:

In track search mode, the LCD will display TRK T000 and flash the highest digit 0 which the SD/MMC card or USB stick contain.

Press the VOL+ or VOL- buttons to select the number of the flashing digit from 0 to 9, and then press the BAND button to confirm the number and flash the next lower digit 0. Following the same steps as above, choose and confirm the digits until the desired track number has been selected and press the BAND button to start playing the track.

FIRST CHARACTER SEARCH mode:

In first character search mode, the display will show the files in alphabetical order from A to Z. and 0 to 9. If the files are not saved by character names the unit will display "NONE" on the screen. Use the VOL+ and VOL- buttons to search through the files and press the SEL button to play the desired file.

DIRECTORY SEARCHMODE

In directory search mode the unit will display the root folder. If there is root folder, the unit will find root folder named "ROOT".

In this mode, you can use the VOL+ or VOL- buttons to select the desired folder then press >>| or |<< button to select the desired track in the folder.

Once the desired folder is selected, you can press the SEL button to start playing the desired track.

20. ST/MO BUTTON

In FM mode, press the ST briefly to select stereo or monosound mode.

21. CLK BUTTON

Press the CLK button briefly to show the time on the display. After 5 seconds, it will return to the previous display.

Press the CLK button and hold for more than 1 second until the real time flashes on the display. Then you can adjust HOUR or MINUTE by press the VOL+ or VOL- button.

22. AUX INPUT JACK

Press the mode button to select auxiliary input playing mode. You can connect external audio device to the front auxiliary input jack.

23. MMC/SD CARD SLOT

In order to play the files in the MMC/SD card, insert the MMC/SD card into the MMC/SD card slot. The system will change into the MMC/SD mode automatically, and then play the first file in the MMC/SD.

Note:

When MMC/SD card and USB stick are both inserted into their slot or socket, the system will change into the playback mode of the last one.

24. USB SOCKET

In order to play the files in the USB stick, turn over the plastic cover cap then insert the USB stick into the USB socket. The system will change into the USB mode automatically, and play the first file from the USB.

When the USB socket is not used, cover the socket with the plastic cap.

25. FLASHING LED

When the front control panel is removed this indicator flashes.

26. RESET BUTTON

Before operating the unit for the first time, or after replacing the car battery or changing the connections. You must reset the unit.

Press this button with a pointed object. This operation will erase the clock setting and stored contents.

27. RELEASE BUTTON

Press the REL button to release the front control panel from the unit chassis, then pull it out to remove it from the chassis.

When the front control panel is removed the LED indicator flashes.

INSTALLATION METHOD

This is an anti-theft installation method.

The main unit wears a METAL MOUNTING SLEEVE.

Please connect the wiring, eg, the Power supply, the Speakers and the Antenna according to the requirements of this Instruction Manual, then install the metal mounting sleeve into the car as per the diagram illustrated below.

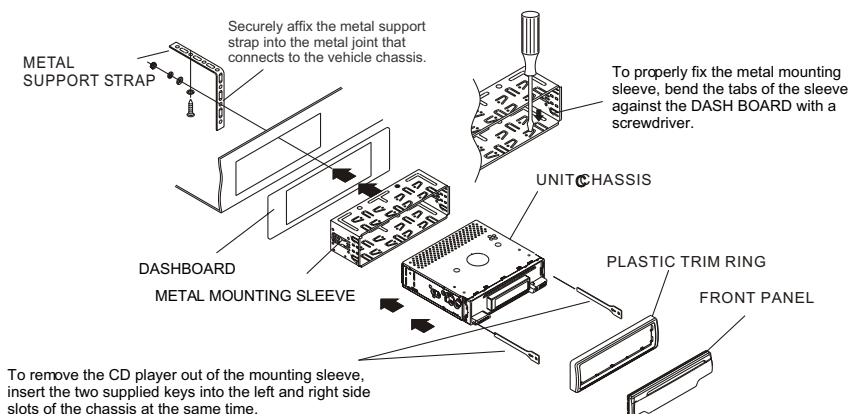

NOTE

Before installing and operating the CD player, remove the metal mounting sleeve illustrated by the arrows.

Remove the two screws that protect the CD mechanism during transportation before operating the player.

To attach the removable faceplate, insert the right side of the faceplate into the right of the CD player chassis first. Then push the left side of the faceplate into the chassis until you hear it "click".

